

NEW 5 CLASSROOM: FOUNDATION REBAR LAYOUT

SCALE 1:100

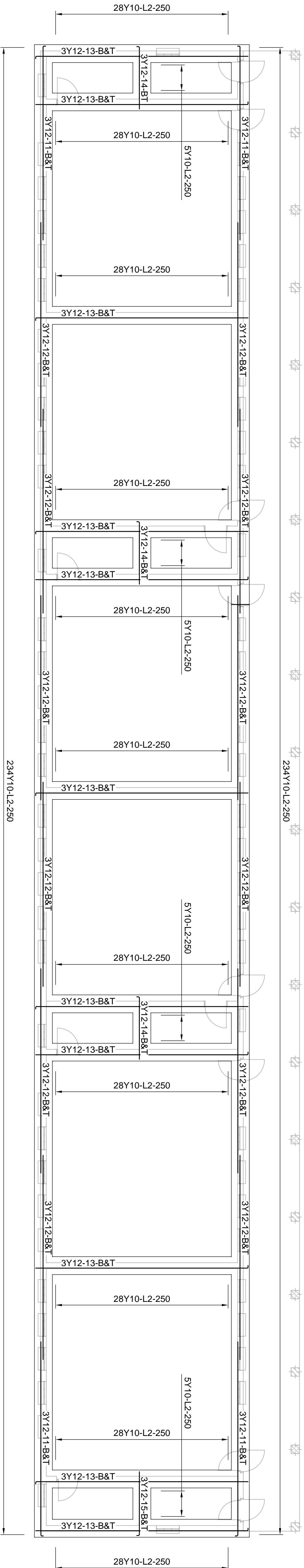

NEW 6 CLASSROOM: FOUNDATION REBAR LAYOUT

SCALE 1:100

- NOTES
- SEE ARCHITECTS DRAWING FOR SETTING OUT INFORMATION.
 - THE CONTRACTOR SHALL GIVE THE ENGINEER AT LEAST 24 HOURS ADVANCE NOTICE FOR INSPECTIONS.
 - THE ENGINEER SHALL BE NOTIFIED WITHOUT DELAY IF ANY DISCREPANCY BETWEEN DRAWINGS, DETAILS AND SPECIFICATIONS ARE FOUND.
 - ALL REQUIREMENTS OF THE LOCAL AUTHORITY SHALL BE FOLLOWED TO THE LETTER WITH RESPECT OF THE CONSTRUCTION PROCEDURES.
 - ONLY WRITTEN DIMENSIONS AND LEVELS SHALL BE USED.
 - WHERE REFERENCE IS MADE TO SOUTH AFRICAN STANDARD SPECIFICATIONS, THE CURRENT EDITION SHALL BE USED.
 - FOUNDATION EXCAVATIONS MUST BE INSPECTED AND APPROVED BY THE ENGINEER BEFORE ANY BLINDING IS CAST.
 - REINFORCEMENT TO BE CHECKED AND APPROVED BY THE ENGINEER PRIOR TO CASTING CONCRETE.
 - CONCRETE STRENGTH AT 28 DAYS
 - FOUNDATIONS - 25MPa
 - COLUMNS - 30MPa
 - BEAMS - 30MPa
 - SLABS - 30MPa
 - FOUNDATIONS - 50mm
 - COLUMNS - 30mm
 - BEAMS - 30mm
 - SLABS - 30mm
 - ALL DIMENSIONS AND LEVELS TO BE CHECKED ON SITE.
 - ALL STEEL UNLESS NOTED OTHERWISE TO BE GRADE 360 W.
 - ALL WELDS TO BE 6mm CONTINUOUS FILLET WELDS.
 - ALL STEEL GRADE 8.8 UNLESS OTHERWISE NOTED.
 - ALL STEELWORK TO BE HOT DIPPED GALVANISED.
 - SHOP DETAIL DRAWINGS TO BE APPROVED BY THE ENGINEER BEFORE FABRICATION OF STEEL WORK.



PROJECT
DBSA SCHOOLS RS
LIKUBU PRIMARY SCHOOL
FREE STATE

DRAWING

FOUNDATION REBAR LAYOUTS
NEW 5 & 6 CLASSROOMS

RESPONSIBLE PERSON	DATE
DESIGNED MG	2022-11-16
DRAWN SR	2022-11-15
CHECKED MG	2022-11-18
APPROVED MAIN GOVENDER PR ENG - 20060411	2022-11-18
SCALE AS SHOWN	SHEET SIZE A1
PROJECT NUMBER DRAWING NUMBER STATUS REVISION	
SAB1777-LPS-321-P-00	
DRAWING STATUS CODES :	
R - REPAIR	T - TENDER
D - DRAFT	P - PRELIMINARY
	C - CONSTRUCTION
	A - AS BUILT
COPYRIGHT RESERVED	